

softwall + softblock weight bearing capacity

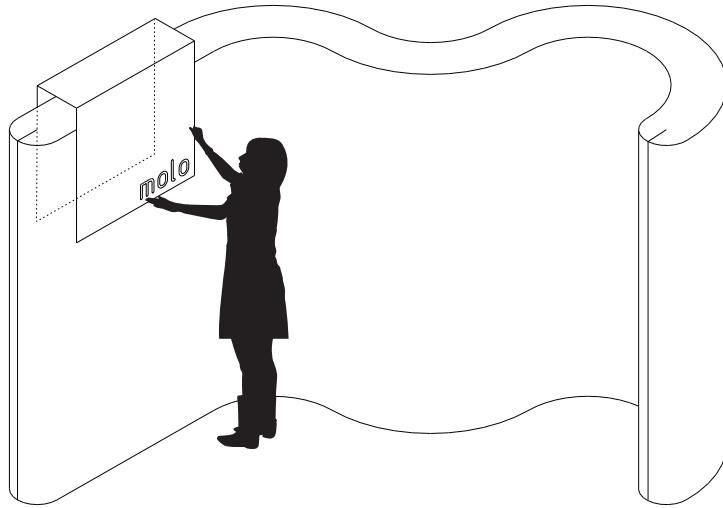

Graphic panels may be hung from softwall using an upside down "U" shape sign.

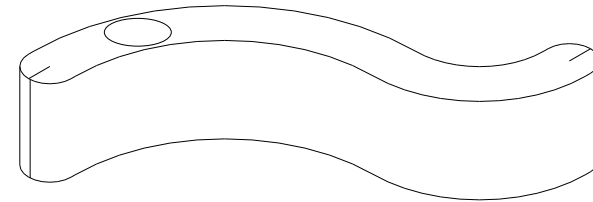

Weight can be distributed across honeycomb cells by placing a tray.

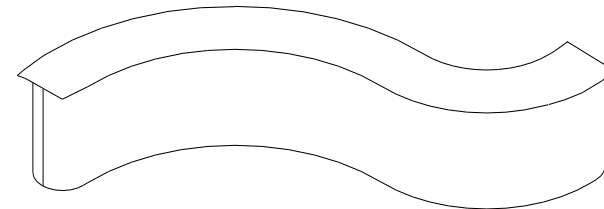

Weight can be distributed by covering a full surface.

material	width	bearing capacity
paper · brown + black	235mm (9.25")	34kg (75lbs) / per linear 305mm (12") / or 165mm (6.5") ø *tray
	340mm (13.3")	68kg (150lbs) / per linear 305mm (12") / or 300mm (11.75") ø *tray
paper · blue	235mm (9.25")	18kg (40lbs) / per linear 305mm (12") / or 165mm (6.5") ø *tray
	340mm (13.3")	34kg (75lbs) / per linear 305mm (12") / or 300mm (11.75") ø *tray
textile · white, black + aluminum	235mm (9.25")	6.5kg (15lbs) / per linear 305mm (12") / or 165mm (6.5") ø *tray
	340mm (13.3")	11kg (25lbs) / per linear 305mm (12") / or 300mm (11.75") ø *tray
FR textile	290mm (11.75")	3kg (7lbs) / per linear 305mm (12") / or 300mm (11.75") ø *tray
	450mm (17.75")	4.5kg (10lbs) / per linear 305mm (12") / or 350mm (13.75") ø *tray
heavyweight textile	450mm (17.75")	45kg (100lbs) / per linear 305mm (12") / or 350mm (13.75") ø *tray

* these tray dimensions are based on molo's small, medium + large steel discs (or larger area spanned by rigid tray-like surface)

* reduce weight for overhead signage, bearing capacities above tested on 910mm (3') tall softblock