

# softwall + softblock weight bearing capacity

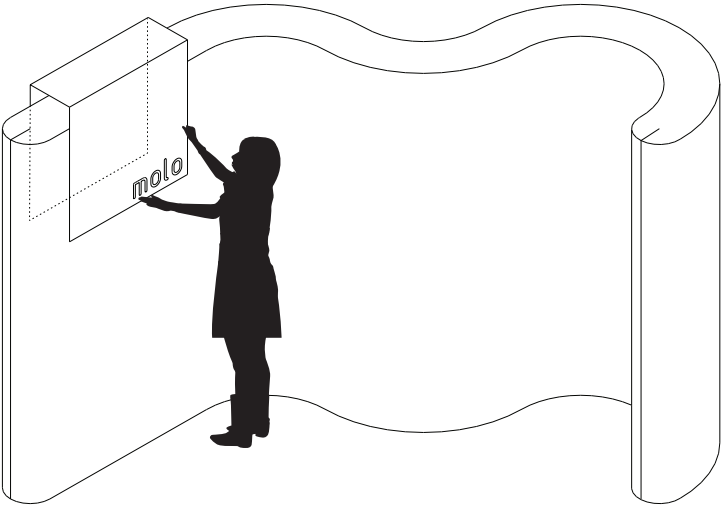

Graphic panels may be hung from softwall using an upside down "U" shape sign.

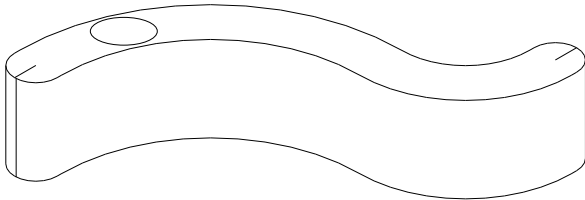

Weight can be distributed across honeycomb cells by placing a tray.

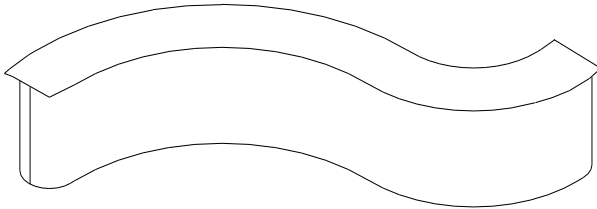

Weight can be distributed by covering a full surface.

| material                | width          | bearing capacity   |
|-------------------------|----------------|--|
| paper · brown + black   | 235mm (9.25")  | 34kg (75lbs) / per linear 305mm (12") / or 165mm (6.5") ø *tray    |
|                         | 340mm (13.3")  | 68kg (150lbs) / per linear 305mm (12") / or 300mm (11.75") ø *tray |
| paper · blue            | 235mm (9.25")  | 18kg (40lbs) / per linear 305mm (12") / or 165mm (6.5") ø *tray    |
|                         | 340mm (13.3")  | 34kg (75lbs) / per linear 305mm (12") / or 300mm (11.75") ø *tray  |
| textile · white + black | 235mm (9.25")  | 6.5kg (15lbs) / per linear 305mm (12") / or 165mm (6.5") ø *tray   |
|                         | 340mm (13.3")  | 11kg (25lbs) / per linear 305mm (12") / or 300mm (11.75") ø *tray  |
| FR textile              | 290mm (11.75") | 3kg (7lbs) / per linear 305mm (12") / or 300mm (11.75") ø *tray    |
|                         | 450mm (17.75") | 4.5kg (10lbs) / per linear 305mm (12") / or 350mm (13.75") ø *tray |
| heavyweight textile     | 450mm (17.75") | 45kg (100lbs) / per linear 305mm (12") / or 350mm (13.75") ø *tray |

\* these tray dimensions are based on molo's small, medium + large steel discs (or larger area spanned by rigid tray-like surface)

\* reduce weight for overhead signage, bearing capacities above tested on 910mm (3') tall softblock